

KLASSIC TOOL CRIB

FLYER

Prices Guaranteed
Thru 6/30/2018

Circling The World With Tools For Fabricating,
Customizing and Restoration

KTC152 Ultimate Kit - \$499.00

This 45 piece kit comes with semi-tubular, oval, AN470, AN455, AN430, AN442 & dimple die sets (male and female) for sizes 3/32, 1/8, 5/32 & 3/16. Also has assorted flush sets. All Sets are .187 shank. Custom Foam molded box with 1 1/2" hand rivet Squeezer and 2" & 3" yokes and quick release pins. The Hand Squeezer has adjustable set holder to easily adapt to multiple riveting applications. Tool is made of Stainless steel and quality craftsmanship.



Includes custom foam molded carrying case.



9350 Harrison
Romulus, MI 48174
(734) 947-8100
(866) 760-6931
Fax: (734) 947-8101

Sales@KlassicToolCrib.com
www.KlassicToolCrib.com

KTC1003 Rivet Gun Kit - \$335.00

This great starter kit includes your choice of either the 3X or 4X rivet gun. Provides the tools you need with four straight rivet sets, two flush sets, four of the most popular bucking bars and two rivet gun springs. Unique design of the carrying case allows the air regulator to remain attached during storage.

Includes: 3x or 4x rivet gun
Straight AN470 rivet sets: 3/32, 1/8, 5/32 & 3/16
Offset AN470 rivet sets: 3/32, 1/8, 5/32, 3/16 & 1/4
1 Flush Set
1 Flush Set with Rubber Guard
Bucking bars: KTC670DB, KTC638DB, KTC647DB, KTC681DB
Air tool regulator: KTC202
Beehive spring: KTC167
Mechaid spring: KTC168
Red molded box.



Toll Free 866.760.6931 Local 734.947.8100 Fax 734.947.8101 Email Sales@KlassicToolCrib.com

www.KlassicToolCrib.com

KTC Rivet Sets - .401 Shank Cupped Rivet Sets

Manufactured from Industrial-Grade high alloy steels
Cupplings of all sets and flush set faces are polished to a high luster
All shanks are precision ground
In addition to the complete range of tools listed, we also welcome specials

All tools heat-treated to exacting standards to insure long tool life
Manufacturing methods assure uniform tools with accurate cupplings
free from all tool marks

AN470 Universal Rivet Set - Straight



Model #	Rivet Body Diameter	Rivet Set Length	Price
SM10-4703	3/32"	3 1/2"	7.00
SM10-4704	1/8"	3 1/2"	7.00
SM10-4705	5/32"	3 1/2"	7.00
SM10-4706	3/16"	3 1/2"	7.00
SM10-4708	1/4"	3 1/2"	7.00

AN470 Universal Rivet Set - 10° Offset



Model #	Rivet Body Diameter	Rivet Set Length	Price
SM20-4703	3/32"	3 1/2"	8.00
SM20-4704	1/8"	3 1/2"	8.00
SM20-4705	5/32"	3 1/2"	8.00
SM20-4706	3/16"	3 1/2"	8.00
SM20-4708	1/4"	3 1/2"	8.00

AN455 Braizer Rivet Set - Straight



Model #	Rivet Body Diameter	Rivet Set Length	Price
SM10-4553	3/32"	3 1/2"	8.00
SM10-4554	1/8"	3 1/2"	8.00
SM10-4555	5/32"	3 1/2"	8.00
SM10-4556	3/16"	3 1/2"	8.00
SM10-4558	1/4"	3 1/2"	9.00

AN430 Round Rivet Set - Straight



Model #	Rivet Body Diameter	Rivet Set Length	Price
SM10-4303	3/32"	3 1/2"	9.50
SM10-4304	1/8"	3 1/2"	9.50
SM10-4305	5/32"	3 1/2"	9.50
SM10-4306	3/16"	3 1/2"	9.50
SM10-4308	1/4"	3 1/2"	9.50

AN450 Tubular Rivet Set - Straight



Model #	Rivet Body Diameter	Rivet Set Length	Price
SM10-4503	3/32"	3 1/2"	16.00
SM10-4504	1/8"	3 1/2"	16.00
SM10-4505	5/32"	3 1/2"	16.00
SM10-4506	3/16"	3 1/2"	16.00
SM10-4508	1/4"	3 1/2"	16.00

AN442 Flat Head Rivet Set - Straight



Model #	Rivet Body Diameter	Rivet Set Length	Price
SM10-4423	3/32"	3 1/2"	9.50
SM10-4424	1/8"	3 1/2"	9.50
SM10-4425	5/32"	3 1/2"	9.50
SM10-4426	3/16"	3 1/2"	9.50
SM10-4428	1/4"	3 1/2"	9.50

Flush Sets - Straight



Model #	Shank	Body Diameter	Length	Price
SM90	.401"	1"	2 1/2"	12.00
SM91	.401"	1"	3"	14.00
SM92	.401"	1"	5 1/2"	19.00
SM94	.401"	1 1/4"	3"	19.00
SM95	.401"	1 1/4"	5 1/2"	20.00

KTC Squeezer Cupped Rivet Sets - .187 Shank

Manufactured from Industrial-Grade high alloy steels
Cupplings of all sets and flush set faces are polished to a high luster
All sets are heat treated to exacting standards to insure long life
Body diameters are ground

Manufacturing methods assure uniformly good tools with accurate cupplings free from all tool marks.

In addition to the complete range of tools listed, we also welcome specials. Squeezer sets also come in .250, .312, & .375 shank diameter.

AN470 Universal Squeezer Sets - .187 Shank

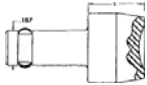

Model #	Rivet Body Diameter	Set Length	Price
SM200-4703	3/32"	1/4"	6.00
SM200-4704	1/8"	1/4"	6.00
SM200-4705	5/32"	1/4"	6.00
SM200-4706	3/16"	1/4"	6.00
SM200-4708	1/4"	1/4"	6.00

KAT Squeezer Flush Rivet Sets - .187 Shank



Model #	Set Body Length	Set Diameter	Price
SM210	3/32"	1/4"	5.50
SM211	1/8"	1/4"	5.50
SM212	5/32"	1/4"	5.50
SM213	3/16"	1/4"	6.00
SM214	1/4"	1/4"	6.00

AN455 Brazier Head Squeezer Sets - .187 Shank



Model #	Rivet Body Diameter	Set Length	Price
SM200-4553	3/32"	1/4"	7.00
SM200-4554	1/8"	1/4"	7.00
SM200-4555	5/32"	1/4"	7.00
SM200-4556	3/16"	1/4"	7.00
SM200-4558	1/4"	1/4"	7.00

AN430 Round Squeezer Sets - .187 Shank



Model #	Rivet Body Diameter	Set Length	Price
SM200-4303	3/32"	1/4"	7.00
SM200-4304	1/8"	1/4"	7.00
SM200-4305	5/32"	1/4"	7.00
SM200-4306	3/16"	1/4"	7.00
SM200-4308	1/4"	1/4"	7.00

AN450 Semi-Tublar Squeezer Sets -.187 Shank



Model #	Rivet Body Diameter	Set Length	Price
SM200-4502	1/16"	1/4"	19.00
SM200-4503	3/32"	1/4"	19.00
SM200-4504	1/8"	1/4"	19.00
SM200-4505	5/32"	1/4"	19.00
SM200-4506	3/16"	1/4"	19.00
SM200-4508	1/4"	1/4"	19.00
SM200-45010	5/16"	1/4"	19.00

Oval Style Set - .187 Shank



Model #	Rivet Body Diameter	Set Length	Price
SM200-2Oval	1/16"	1/4"	16.00
SM200-3Oval	3/32"	1/4"	16.00
SM200-4Oval	1/8"	1/4"	16.00
SM200-5Oval	5/32"	1/4"	16.00
SM200-6Oval	3/16"	1/4"	16.00
SM200-8Oval	1/4"	1/4"	16.00
SM200-10Oval	5/16"	1/4"	16.00

KTC164-CFDK Squeezer Set Kit - \$99.00

Comes with:

- 4 AN470 squeezer sets (3/32, 1/8, 5/32, & 3/16)
- 4 Dimple Die Sets (male and female) (3/32, 1/8, 5/32, & 3/16)
- 7 Flush Sets with thickness of 1/8, 3/16, 1/4, 5/16, 3/8, 7/16 & 1/2

All have .187 standard shank size. Highly polished heat treated steel sets. Comes in a FOD style carrying case.





Eckold HF100 HandFormer



HF100K

HF100PA100K

Model #	Reach x Gap	Aluminum Capacity	Steel Capacity	Stainless Capacity	Shipping Weight	Price
HF100	4" x 2 1/4"	0.078	0.059	0.039	69 lbs	\$2,240.00
HF100K	4" x 2 1/4"	0.078	0.059	0.039	76 lbs	\$3,790.00
HF100PA100K	4" x 2 1/4"	0.078	0.059	0.039	105 lbs	\$6,585.00

The Eckold HF100 series handformer is a stationary machine with a manual drive that replaces laborious hammer work when forming metal. It is suitable for shrinking and stretching metal sheets and profiles up to a thickness of 1.5 mm (16 gauge). The single stroke of the handformer makes it possible to operate tools for notching, punching and edging. The HF100K includes one set of FWA405SSP Shrinking and FWR407SSP Stretching Jaws. The HF100PA100K is equipped with a pneumatic drive and foot pedal which allows for hands free operation. Also includes: FWA405SSP and FWR407SSP. Additional tooling available. View instructional videos at www.KlassicToolCrib.com.

GL2 Deluxe - \$2,605.00



Description	Material	Dimension
GL2 Planishing Hammer		
Planishing Insert	Steel	1.89" - R 19.685"
Curving Insert	Steel	0.71" x 1.575" - R 19.685"
Stretching Insert	Steel	1.575" - R 2.362"
Stretching Insert	Steel	1.575" - R 1.969"
Stretching Insert	Steel	1.89" - R 2.756"
Planishing Insert	Synthetic	1.89" - R 19.685"
Bank (Rectangular)	Synthetic	0.71" X 1.575" - Flat
Stretching Insert	Synthetic	1.575" - R 2.362"
Stretching	Synthetic	1.89" - 2.756"
Blank (Round) 3 pcs	Synthetic	1.89" - Flat
Regular Shaft	For Synthetic	1.575"
Swivel Shaft	For Synthetic	1.575"

HZ52 Hand Plier

The Eckold hand pliers HZ52 are specially designed for making adjustments and corrections at the worksite by stretching and even shrinking. They can handle sheet metal and profiles up to .039" thickness or aluminum up to .059" thickness. HZ52 hand pliers are used for correcting or adjusting metal profiles and sheet flanges by shrinking or stretching.

Model #	Aluminum Capacity	Steel Capacity	Stainless Capacity	Weight	Price
HZ52	0.078	0.059	0.039	8.37 lbs	\$1,165.00



Throat Vertical	Total Length	Clinching Variants
2.75"	27"	S-DF 4

Model #	Type	Function	Price
FWA405 (STD)	40mm	Shrinking	\$665.00
FWR407 (STD)	40 mm	Stretching	\$665.00



Toll Free 866.760.6931 Local 734.947.8100 Fax 734.947.8101 Email Sales@KlassicToolCrib.com